

NIRMALA DEVELOPERS

Date:

West Bengal Real Estate Regulatory Authority

Calcutta Green's Commercial complex, 1st Floor,

1050/2, Survey Park, Kolkata- 700075.

Sub: Location Details of Project

Sir,

We are enclosing herewith the location details of the project NIRMALA ORCHID, with clear demarcation of land dedicated for the project along with its boundaries including the latitude and longitude of the end points of the project.

Thanking you

Yours faithfully,

Nirmala Developers

Aayush Tekchand
Partner



Regd. Off. : 312, Laketown, Block A, Near P.S. Laketown. Kolkata - 700 089.

☎ : 75959 27970, ✉ : nirmalagroup4u@gmail.com, 🌐 : www.nirmalagroups.com

NIRMALA DEVELOPERS

SITE PLAN OF THE PLOT FOR PROPOSED BUILDING AS PER RULES AT HOLDING NO. - 897/A [NEW] 427 [OLD], DAKSHINDARI ROAD; KOLKATA- 700048, MOUZA- KANKURI, DAG NO. - 213; KHATIAN NO. - 240,104,34,39; J.L. NO. - 28, WARD NO. - 34; CIRCLE NO. - 7; P.S. - LAKE TOWN, 24 PGD. [NORTH] UNDER SOUTH DUM-DUM MUNICIPALITY.

LATITUDE : 22.59992
 LONGITUDE : 88.4009
 N - 22° 35' 59.69544"
 E - 88° 24' 3.24"

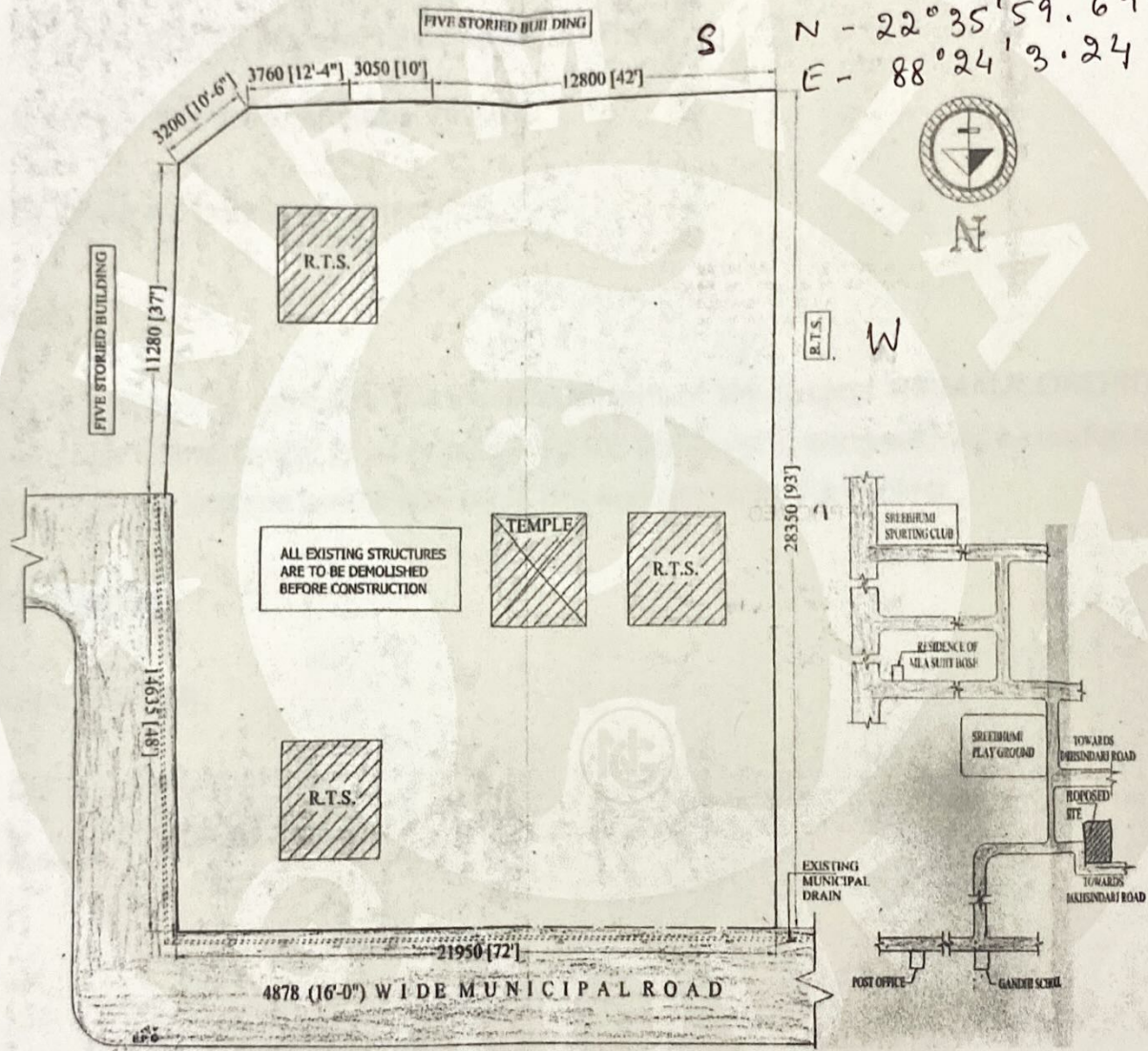

N
 Nirmala Developers
 Ayazul Tekrind.
 Partner